

CS 250

180+180 Watt max 4+4 Ω

Ø 250 mm / 10"

SUB WOOFER

Doppia bobina mobile, membrana in cellulosa smorzata e sospensione in tela

Dual coil, doped paper cone, fabric surround

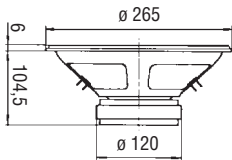

Potenza nominale	80+80 W	Re	3+3 Ω	D	213 mm
Impedenza nominale	4+4 Ω	Fs	50 Hz	Vas	65 dm³
Sensibilità (1W/1m)	95 dB	Qms	2,59	BxI	4,96 Wb/m
Ø bobina mobile	38 mm	Qes	0,6	Xmax	3,5 mm
Altezza traferro	8 mm	Qts	0,49	η°	1,48 %
Fori di fissaggio	8 $\varnothing 6$ / $\varnothing 249$	Mms	25 g	Le	0,2 mH
Foro pannello	238 mm	Cms	0,36 mm/N	Peso	2,7 Kg

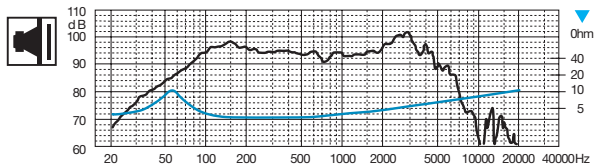

Parametri rilevati con bobine mobili in parallelo

Parameters taken with coils in parallel